

INDEX OF SCHEDULES  
CITY OF NANTICOKE

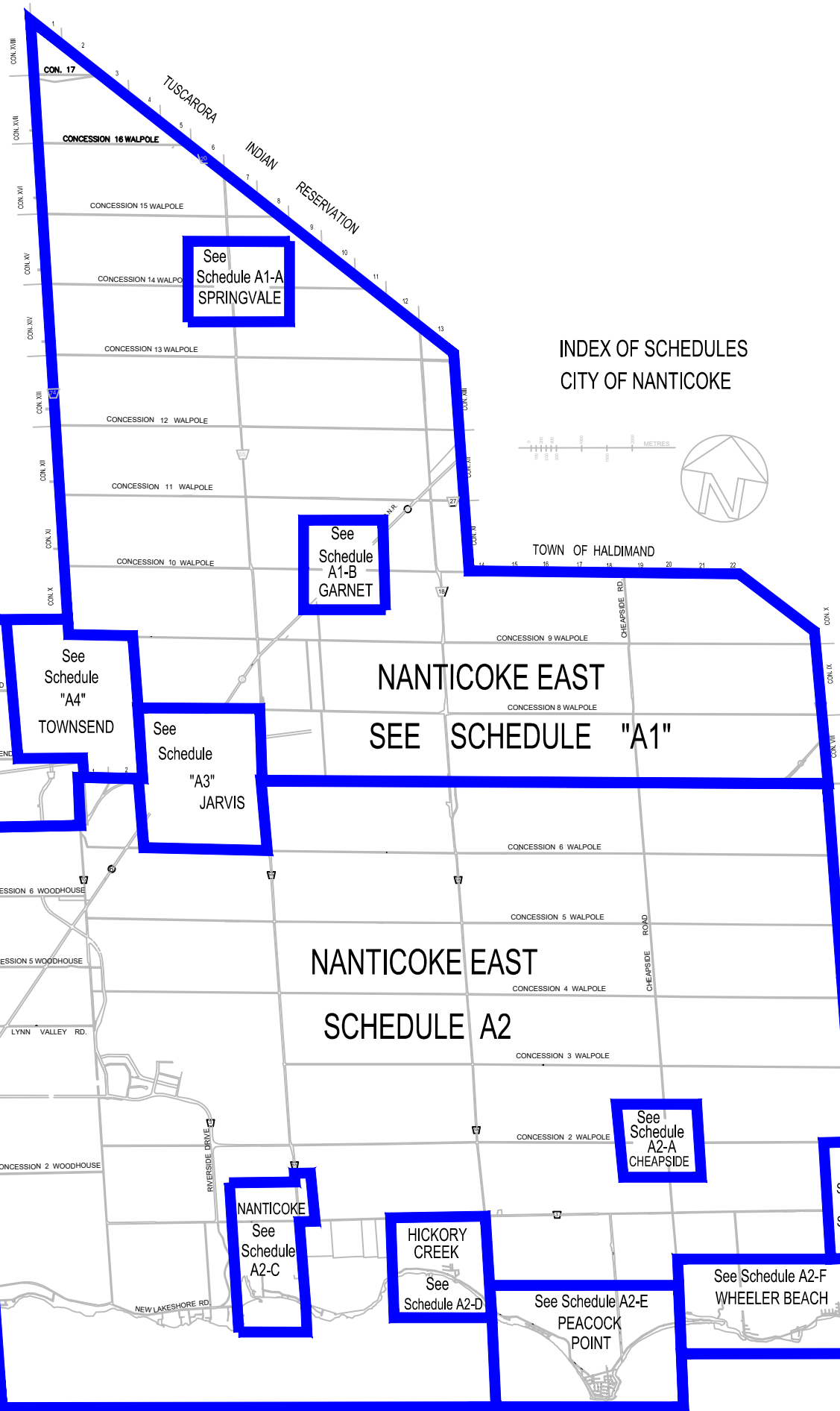

See  
Schedule A1-A  
SPRINGVALE

See  
Schedule  
A1-B  
GARNET

CONCESSION 13, TOWNSEND  
CONCESSION 14, TOWNSEND  
**"A1"**

See  
Schedule  
"A4"  
TOWNSEND

See  
Schedule  
"A3"  
JARVIS

NANTICOKE EAST  
CONCESSION 8 WALPOLE  
CONCESSION 9 WALPOLE  
SEE SCHEDULE "A1"

NANTICOKE EAST  
CONCESSION 4 WALPOLE  
CONCESSION 5 WALPOLE  
CONCESSION 6 WALPOLE  
SCHEDULE A2

See  
Schedule  
A2-A  
CHEAPSIDE

See  
Schedule  
A2-B  
SELKIRK

NANTICOKE  
See  
Schedule  
A2-C

HICKORY  
CREEK  
See  
Schedule  
A2-D

See Schedule A2-E  
PEACOCK  
POINT

See Schedule A2-F  
WHEELER BEACH

FORMER  
TWP. OF  
NANTICOKE  
WOODHOUSE

FORMER  
TWP. OF  
RAINHAM  
OF  
HALDIMAND

LAKE ERIE

# NANTICOKE EAST SCHEDULE A1

OFFICE CONSOLIDATION  
AUG 2020

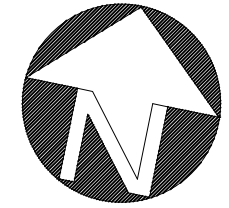
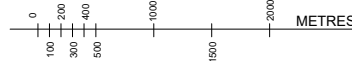

### Zone Categories

#### RESIDENTIAL ZONES

- R1-A URBAN RESIDENTIAL TYPE 1-A ZONE
- R1-B URBAN RESIDENTIAL TYPE 1-B ZONE
- R2 URBAN RESIDENTIAL TYPE 2 ZONE
- R3 URBAN RESIDENTIAL TYPE 3 ZONE
- R4 URBAN RESIDENTIAL TYPE 4 ZONE
- RM URBAN RESIDENTIAL MIXED ZONE
- R5 URBAN RESIDENTIAL TYPE 5 ZONE
- RH HAMLET RESIDENTIAL ZONE
- RV VACATION RESIDENTIAL ZONE

#### COMMERCIAL ZONES

- CD DOWNTOWN COMMERCIAL ZONE
- CH HIGHWAY COMMERCIAL ZONE
- CN NEIGHBOURHOOD COMMERCIAL ZONE
- CHA HAMLET COMMERCIAL ZONE
- CR RURAL COMMERCIAL ZONE
- CMT MARINE-TOURIST COMMERCIAL ZONE

#### INDUSTRIAL ZONES

- MH HEAVY INDUSTRIAL ZONE
- MG GENERAL INDUSTRIAL ZONE
- MP PRESTIGE INDUSTRIAL ZONE
- MR RURAL INDUSTRIAL ZONE
- MD DISPOSAL INDUSTRIAL ZONE
- MI EXTRACTIVE INDUSTRIAL ZONE

#### INSTITUTIONAL ZONES

- IC COMMUNITY INSTITUTIONAL ZONE
- IN NEIGHBOURHOOD INSTITUTIONAL ZONE
- IR RURAL INSTITUTIONAL ZONE

#### OPEN SPACE AND HAZARD LANDS ZONES

- OS OPEN SPACE ZONE
- OST OPEN SPACE TENT AND TRAILER ZONE
- HL HAZARD LAND ZONE

#### AGRICULTURAL ZONES

- A AGRICULTURAL ZONE

#### FUTURE DEVELOPMENT ZONES

- D DEVELOPMENT ZONE

### Legend

- SCHEDULE BOUNDARY
- ZONE BOUNDARY
- BOUNDARY OF LAND HAVING REFERENCE TO SPECIAL PROVISIONS OF THIS BY-LAW
- BOUNDARY OF LAND HAVING REFERENCE TO SPECIAL PROVISIONS OF THIS BY-LAW
- OFF STREET PARKING AREA (BY-LAW 632-HC-09)

\*NOTE: According to Section 1.4.8 of this By-law, all lands within R3, R4, R5, RM, CD, CN, CH, CHA, CR, CMT, MG, MH, MP, MR, MD, MX, IC, IN, IR, OS, OST, and HL zones are site plan control areas by By-law 749-HC/11

++NOTE: All Lands within the CH, CR, MH, MG and MR zones of Zoning By-Law NE 1-2000 are subject to By-Laws 1049-HC/18 & 1052-HC/18 which permits the use of a Scrap Material Collection Bin for a period of up to two (2) years expiring on Feb 12, 2020

FORMER TWP. OF TOWNSEND

NANTICOKE WEST

TOWN OF HALDIMAND

FORMER TWP. OF RAINHAM  
TOWN OF HALDIMAND

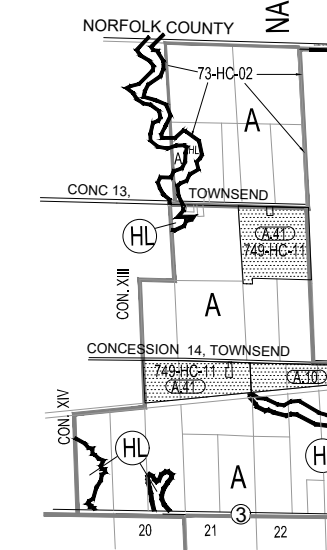
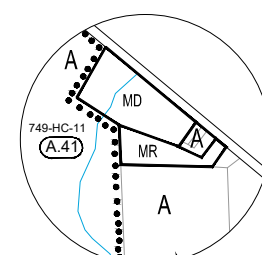
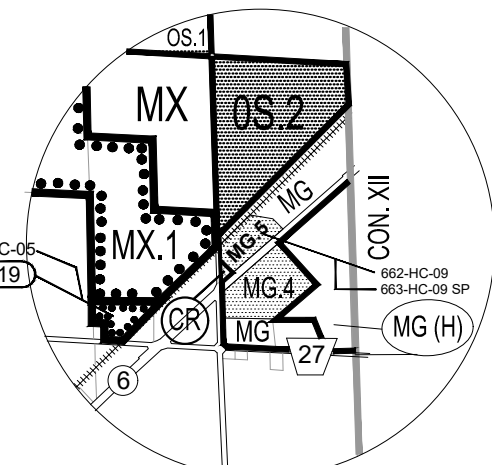
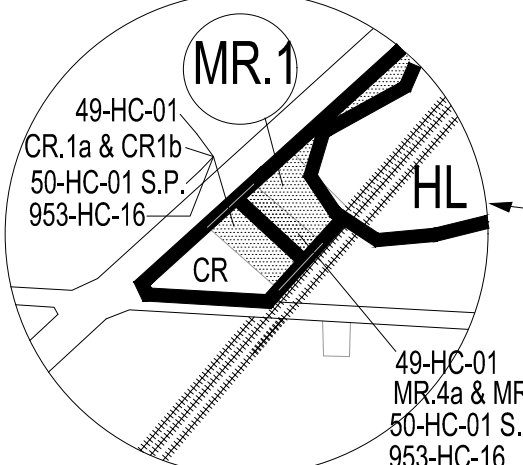
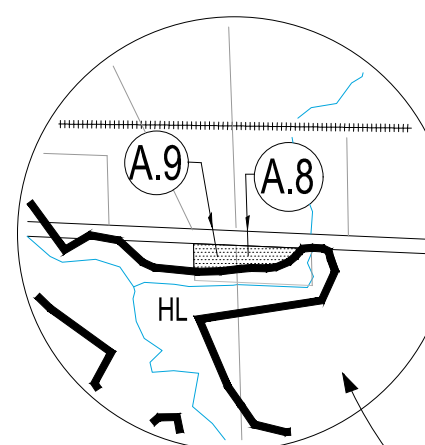
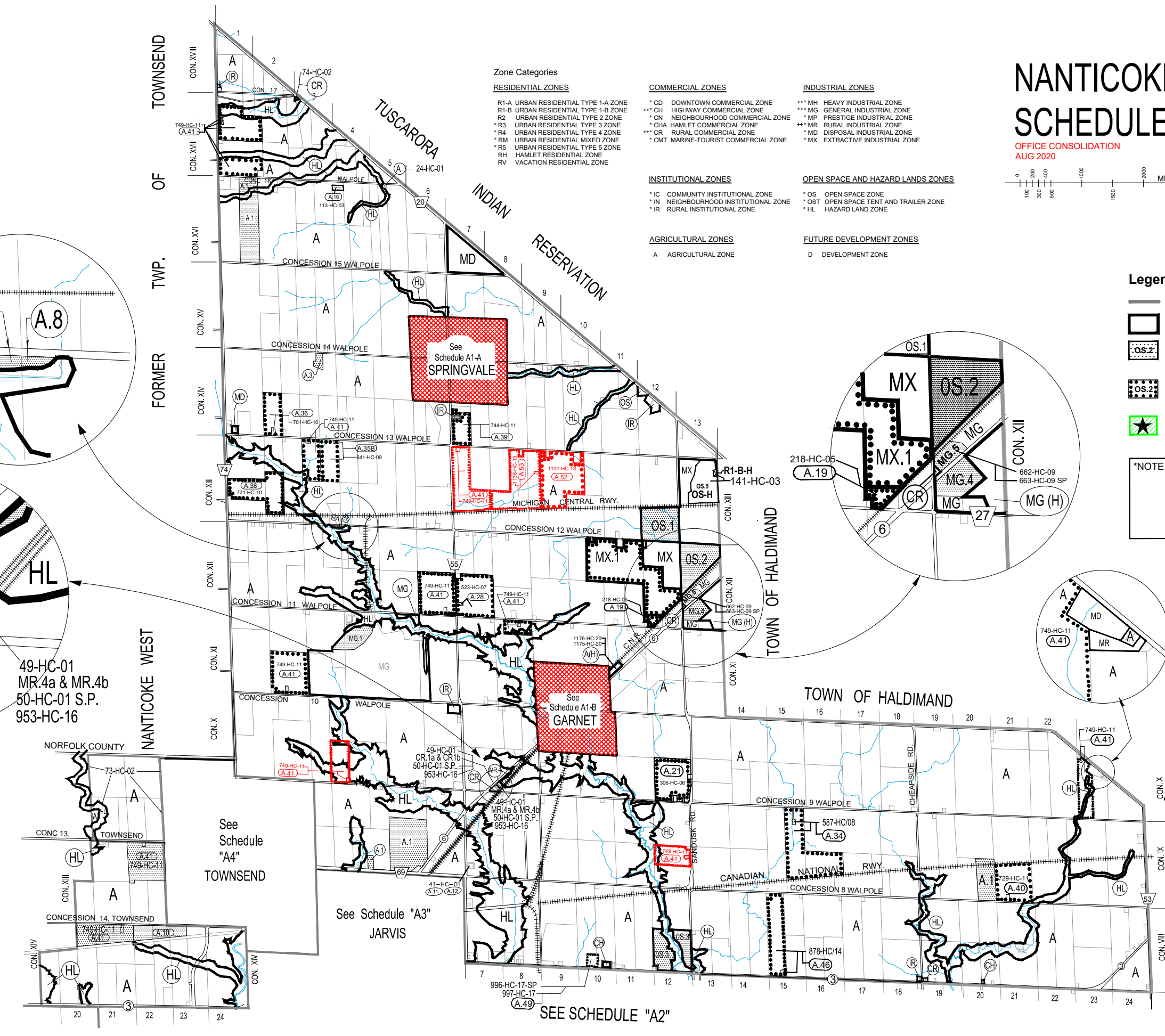

See Schedule "A3"  
JARVIS

SEE SCHEDULE "A2"

See Schedule "A4"  
TOWNSEND

See Schedule A1-B  
GARNET

See Schedule A1-A  
SPRINGVALE

49-HC-01  
MR.4a & MR.4b  
50-HC-01 S.P.  
953-HC-16

49-HC-01  
CR.1a & CR1b  
50-HC-01 S.P.  
953-HC-16

218-HC-05  
A.19

662-HC-09  
663-HC-09 SP  
MG (H)

49-HC-01  
CR.1a & CR1b  
50-HC-01 S.P.  
953-HC-16

587-HC-08  
A.34

878-HC-14  
A.46

749-HC-11  
A.40

749-HC-11  
A.41

996-HC-17-SP  
997-HC-17  
A.49

73-HC-02  
A

749-HC-11  
A.41

749-HC-11  
A.41

749-HC-11  
A.41

749-HC-11  
A.41

749-HC-11  
A.41

749-HC-11  
A.41

749-HC-11  
A.41

41-HC-06  
A.11

41-HC-06  
A.11

41-HC-06  
A.11

41-HC-06  
A.11

749-HC-11  
A.41

749-HC-11  
A.41

749-HC-11  
A.41

749-HC-11  
A.41

306-HC-08  
A.21

306-HC-08  
A.21

306-HC-08  
A.21

306-HC-08  
A.21

523-HC-07  
A.28

523-HC-07  
A.28

523-HC-07  
A.28

523-HC-07  
A.28

749-HC-11  
A.41

749-HC-11  
A.41

749-HC-11  
A.41

749-HC-11  
A.41

1176-HC-20  
1176-HC-20A  
A(H)

1176-HC-20  
1176-HC-20A  
A(H)

1176-HC-20  
1176-HC-20A  
A(H)

1176-HC-20  
1176-HC-20A  
A(H)

749-HC-11  
A.41

749-HC-11  
A.41

749-HC-11  
A.41

749-HC-11  
A.41

**NANTICOKE EAST  
SCHEDULE A1-A  
SPRINGVALE  
SCHEDULE A1-B  
GARNET**

OFFICE CONSOLIDATION  
FEB 2020

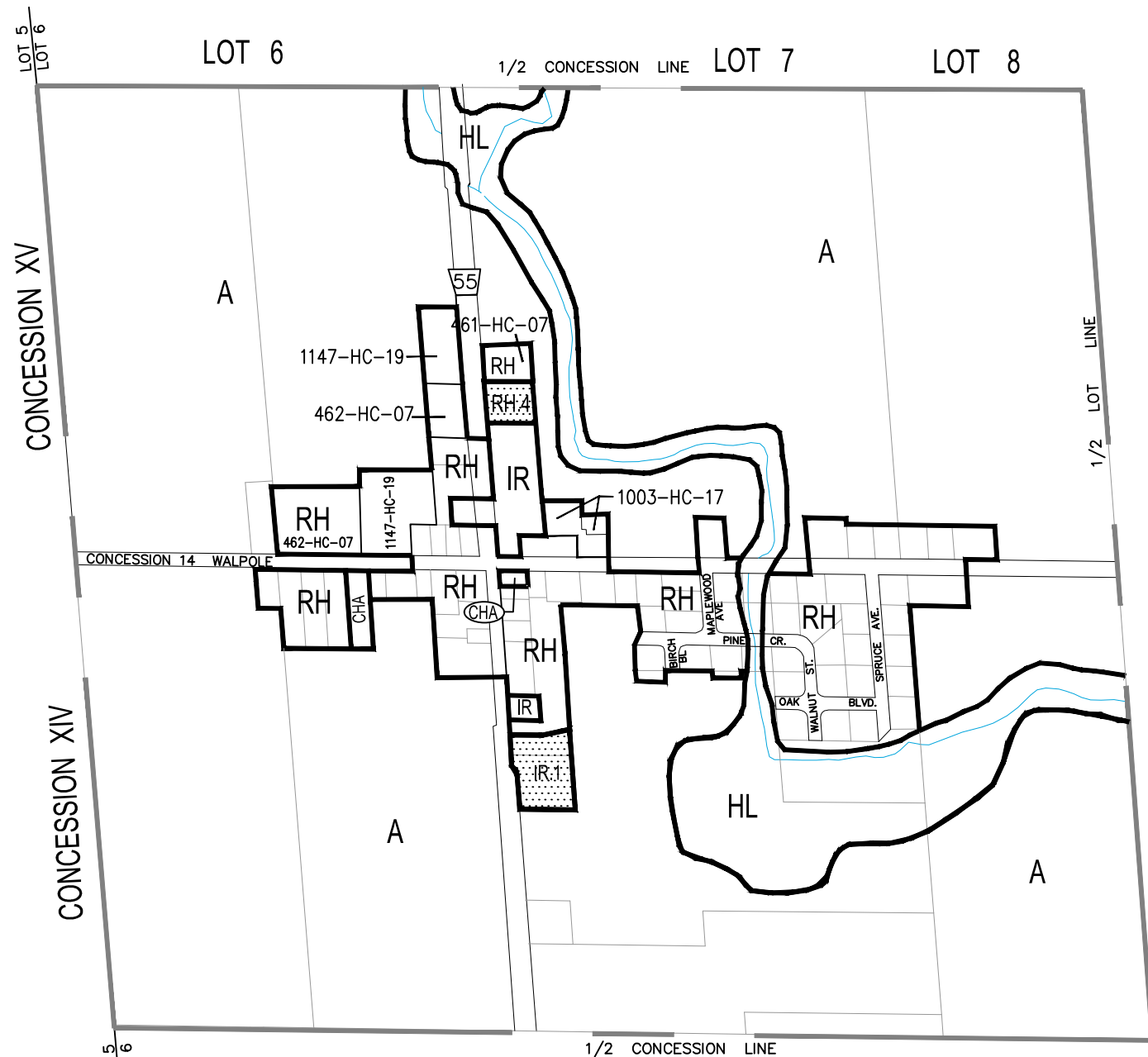
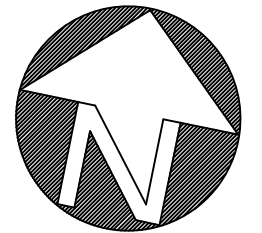
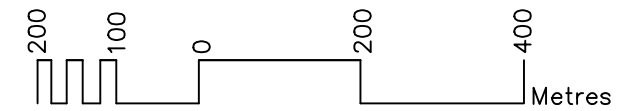

**SCHEDULE A1-A  
SPRINGVALE**

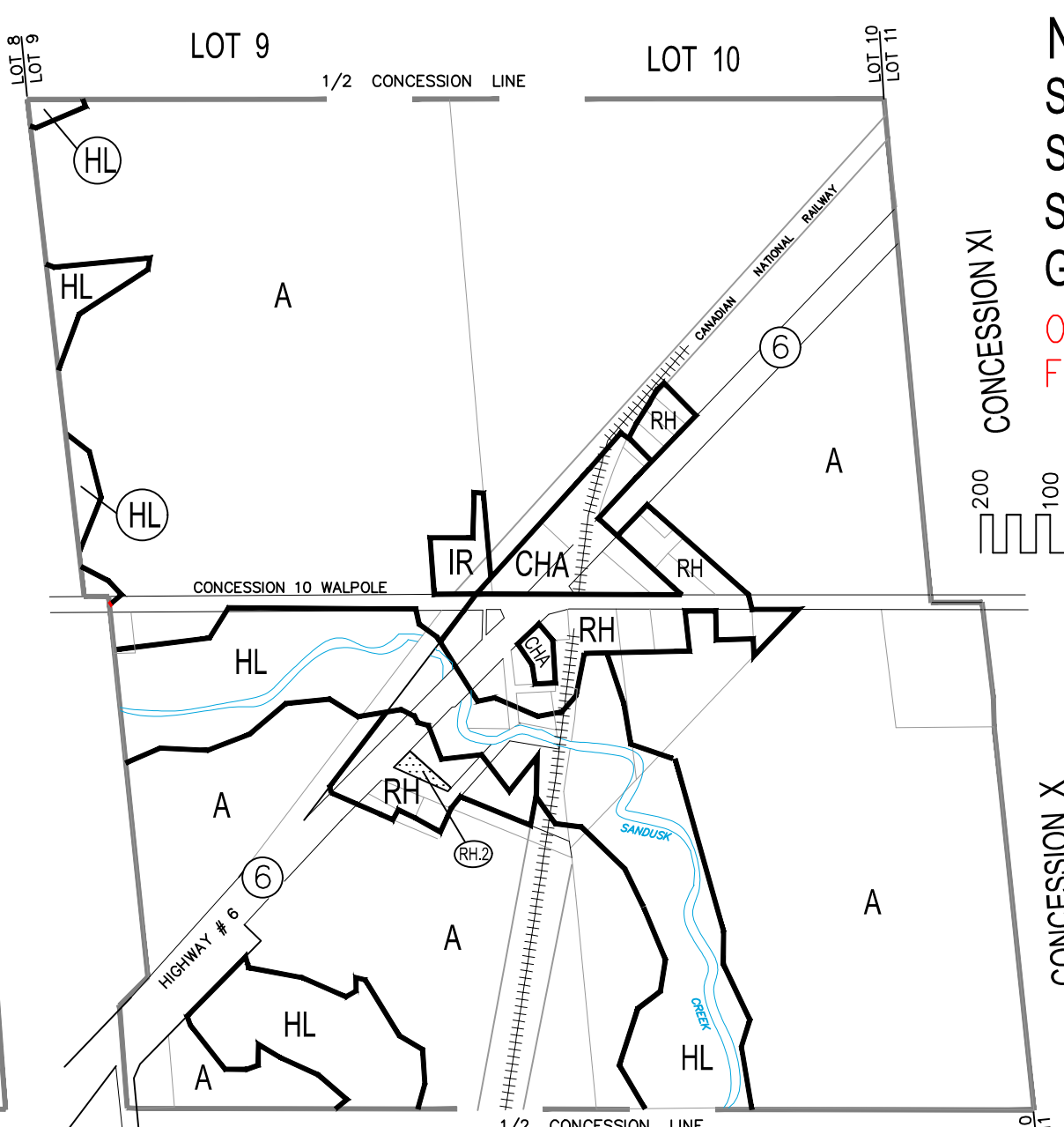

**SCHEDULE A1-B  
GARNET**

**Zone Categories**

RESIDENTIAL ZONES

- R1-A URBAN RESIDENTIAL TYPE 1-A ZONE
- R1-B URBAN RESIDENTIAL TYPE 1-B ZONE
- R2 URBAN RESIDENTIAL TYPE 2 ZONE
- \* R3 URBAN RESIDENTIAL TYPE 3 ZONE
- \* R4 URBAN RESIDENTIAL TYPE 4 ZONE
- \* RM URBAN RESIDENTIAL MIXED ZONE
- \* R5 URBAN RESIDENTIAL TYPE 5 ZONE
- RH HAMLET RESIDENTIAL ZONE
- RV VACATION RESIDENTIAL ZONE

COMMERCIAL ZONES

- \* CD DOWNTOWN COMMERCIAL ZONE
- \*\* CH HIGHWAY COMMERCIAL ZONE
- \* CN NEIGHBOURHOOD COMMERCIAL ZONE
- \* CHA HAMLET COMMERCIAL ZONE
- \*\* CR RURAL COMMERCIAL ZONE
- \* CMT MARINE-TOURIST COMMERCIAL ZONE

AGRICULTURAL ZONES

- A AGRICULTURAL ZONE

INDUSTRIAL ZONES

- \*\*\* MH HEAVY INDUSTRIAL ZONE
- \*\*\* MG GENERAL INDUSTRIAL ZONE
- \* MP PRESTIGE INDUSTRIAL ZONE
- \*\*\* MR RURAL INDUSTRIAL ZONE
- \* MD DISPOSAL INDUSTRIAL ZONE
- \* MX EXTRACTIVE INDUSTRIAL ZONE

FUTURE DEVELOPMENT ZONES

- D DEVELOPMENT ZONE

INSTITUTIONAL ZONES

- \* IC COMMUNITY INSTITUTIONAL ZONE
- \* IN NEIGHBOURHOOD INSTITUTIONAL ZONE
- \* IR RURAL INSTITUTIONAL ZONE

OPEN SPACE AND HAZARD LANDS ZONES

- \* OS OPEN SPACE ZONE
- \* OST OPEN SPACE TENT AND TRAILER ZONE
- \* HL HAZARD LAND ZONE

**Legend**

- SCHEDULE BOUNDARY
- ZONE BOUNDARY
- BOUNDARY OF LAND HAVING REFERENCE TO SPECIAL PROVISIONS OF THIS BY-LAW
- BOUNDARY OF LAND HAVING REFERENCE TO SPECIAL PROVISIONS OF THIS BY-LAW
- OFF STREET PARKING AREA (BY-LAW 632-HC-09)

\*NOTE: According to Section 1.4.8 of this By-law, all lands within R3, R4, R5, RM, CD, CN, CH, CHA, CR, CMT, MG, MH, MP, MR, MD, MX, IC, IN, IR, OS, OST, and HL zones are site plan control areas by By-law 749-HC/11

++NOTE: All Lands within the CH, CR, MH, MG and MR zones of Zoning By-Law NE 1-2000 are subject to By-Laws 1049-HC/18 & 1052-HC/18 which permits the use of a Scrap Material Collection Bin for a period of up to two (2) years expiring on Feb 12, 2020

# NANTICOKE EAST SCHEDULE A2

OFFICE CONSOLIDATION  
AUG 2020

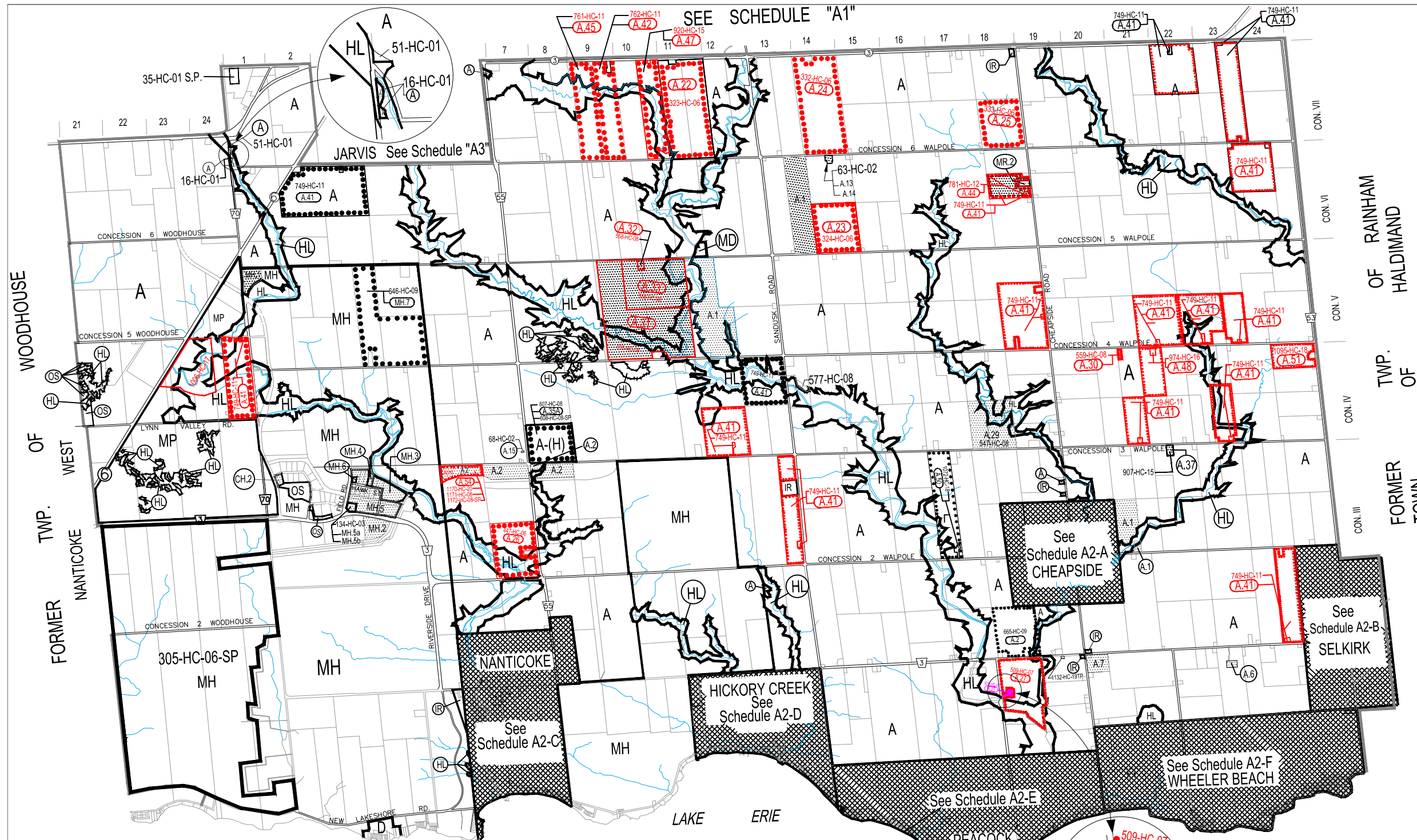
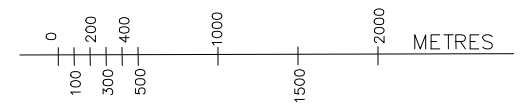
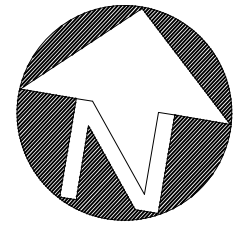

## Zone Categories

### RESIDENTIAL ZONES

- R1-A URBAN RESIDENTIAL TYPE 1-A ZONE
- R1-B URBAN RESIDENTIAL TYPE 1-B ZONE
- R2 URBAN RESIDENTIAL TYPE 2 ZONE
- \* R3 URBAN RESIDENTIAL TYPE 3 ZONE
- \* R4 URBAN RESIDENTIAL TYPE 4 ZONE
- \* RM URBAN RESIDENTIAL MIXED ZONE
- \* R5 URBAN RESIDENTIAL TYPE 5 ZONE
- RH HAMLET RESIDENTIAL ZONE
- RV VACATION RESIDENTIAL ZONE

### AGRICULTURAL ZONES

- A AGRICULTURAL ZONE

### COMMERCIAL ZONES

- \* CD DOWNTOWN COMMERCIAL ZONE
- \*\*\* CH HIGHWAY COMMERCIAL ZONE
- \* CN NEIGHBOURHOOD COMMERCIAL ZONE
- \* CHA HAMLET COMMERCIAL ZONE
- \*\*\* CR RURAL COMMERCIAL ZONE
- \* CMT MARINE-TOURIST COMMERCIAL ZONE

### INSTITUTIONAL ZONES

- \* IC COMMUNITY INSTITUTIONAL ZONE
- \* IN NEIGHBOURHOOD INSTITUTIONAL ZONE
- \* IR RURAL INSTITUTIONAL ZONE

### INDUSTRIAL ZONES

- \*\*\* MH HEAVY INDUSTRIAL ZONE
- \*\*\* MG GENERAL INDUSTRIAL ZONE
- \* MP PRESTIGE INDUSTRIAL ZONE
- \*\*\* MR RURAL INDUSTRIAL ZONE
- \* MD DISPOSAL INDUSTRIAL ZONE
- \* MX EXTRACTIVE INDUSTRIAL ZONE

### OPEN SPACE AND HAZARD LANDS ZONES

- \* OS OPEN SPACE ZONE
- \* OST OPEN SPACE TENT AND TRAILER ZONE
- \* HL HAZARD LAND ZONE

### FUTURE DEVELOPMENT ZONES

- D DEVELOPMENT ZONE

## Legend

- SCHEDULE BOUNDARY
- ZONE BOUNDARY
- BOUNDARY OF LAND HAVING REFERENCE TO SPECIAL PROVISIONS OF THIS BY-LAW
- BOUNDARY OF LAND HAVING REFERENCE TO SPECIAL PROVISIONS OF THIS BY-LAW
- OFF STREET PARKING AREA (BY-LAW 632-HC-09)

\*NOTE: According to Section 1.4.8 of this By-law, all lands within R3, R4, R5, RM, CD, CN, CH, CHA, CR, CMT, MG, MH, MP, MR, MD, MX, IC, IN, IR, OS, OST, and HL zones are site plan control areas by By-law 749-HC/11

\*\*\*NOTE: All Lands within the CH, CR, MH, MG and MR zones of Zoning By-Law NE 1-2000 are subject to By-Laws 1049-HC/18 & 1052-HC/18 which permits the use of a Scrap Material Collection Bin for a period of up to two (2) years expiring on Feb 12, 2020

LOT 17 LOT 18

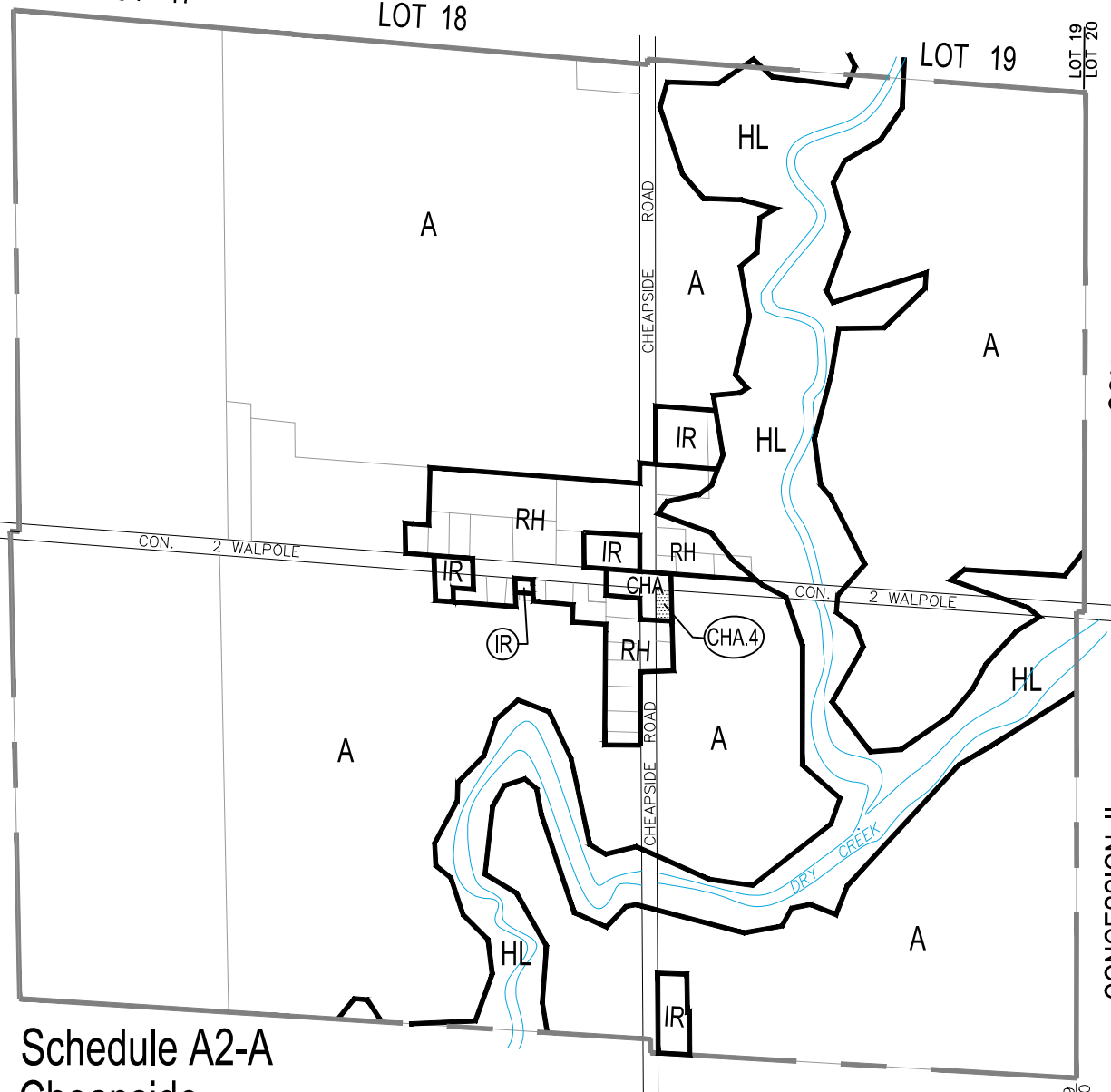

**Schedule A2-A  
Cheapside**

- Zone Categories**
- RESIDENTIAL ZONES**
- R1-A URBAN RESIDENTIAL TYPE 1-A ZONE
  - R1-B URBAN RESIDENTIAL TYPE 1-B ZONE
  - R2 URBAN RESIDENTIAL TYPE 2 ZONE
  - R3 URBAN RESIDENTIAL TYPE 3 ZONE
  - R4 URBAN RESIDENTIAL TYPE 4 ZONE
  - RM URBAN RESIDENTIAL MIXED ZONE
  - R5 URBAN RESIDENTIAL TYPE 5 ZONE
  - RH HAMLET RESIDENTIAL ZONE
  - RV VACATION RESIDENTIAL ZONE
- COMMERCIAL ZONES**
- CD DOWNTOWN COMMERCIAL ZONE
  - CH HIGHWAY COMMERCIAL ZONE
  - CN NEIGHBOURHOOD COMMERCIAL ZONE
  - CHA HAMLET COMMERCIAL ZONE
  - CR RURAL COMMERCIAL ZONE
  - CMT MARINE-TOURIST COMMERCIAL ZONE
- INSTITUTIONAL ZONES**
- IC COMMUNITY INSTITUTIONAL ZONE
  - IN NEIGHBOURHOOD INSTITUTIONAL ZONE
  - IR RURAL INSTITUTIONAL ZONE

- INDUSTRIAL ZONES**
- MH HEAVY INDUSTRIAL ZONE
  - MG GENERAL INDUSTRIAL ZONE
  - MP PRESTIGE INDUSTRIAL ZONE
  - MR RURAL INDUSTRIAL ZONE
  - MD DISPOSAL INDUSTRIAL ZONE
  - MX EXTRACTIVE INDUSTRIAL ZONE

- OPEN SPACE AND HAZARD LANDS ZONES**
- OS OPEN SPACE ZONE
  - OST OPEN SPACE TENT AND TRAILER ZONE
  - HL HAZARD LAND ZONE

- FUTURE DEVELOPMENT ZONES**
- D DEVELOPMENT ZONE
- AGRICULTURAL ZONES**
- A AGRICULTURAL ZONE

LOT 23 LOT 24

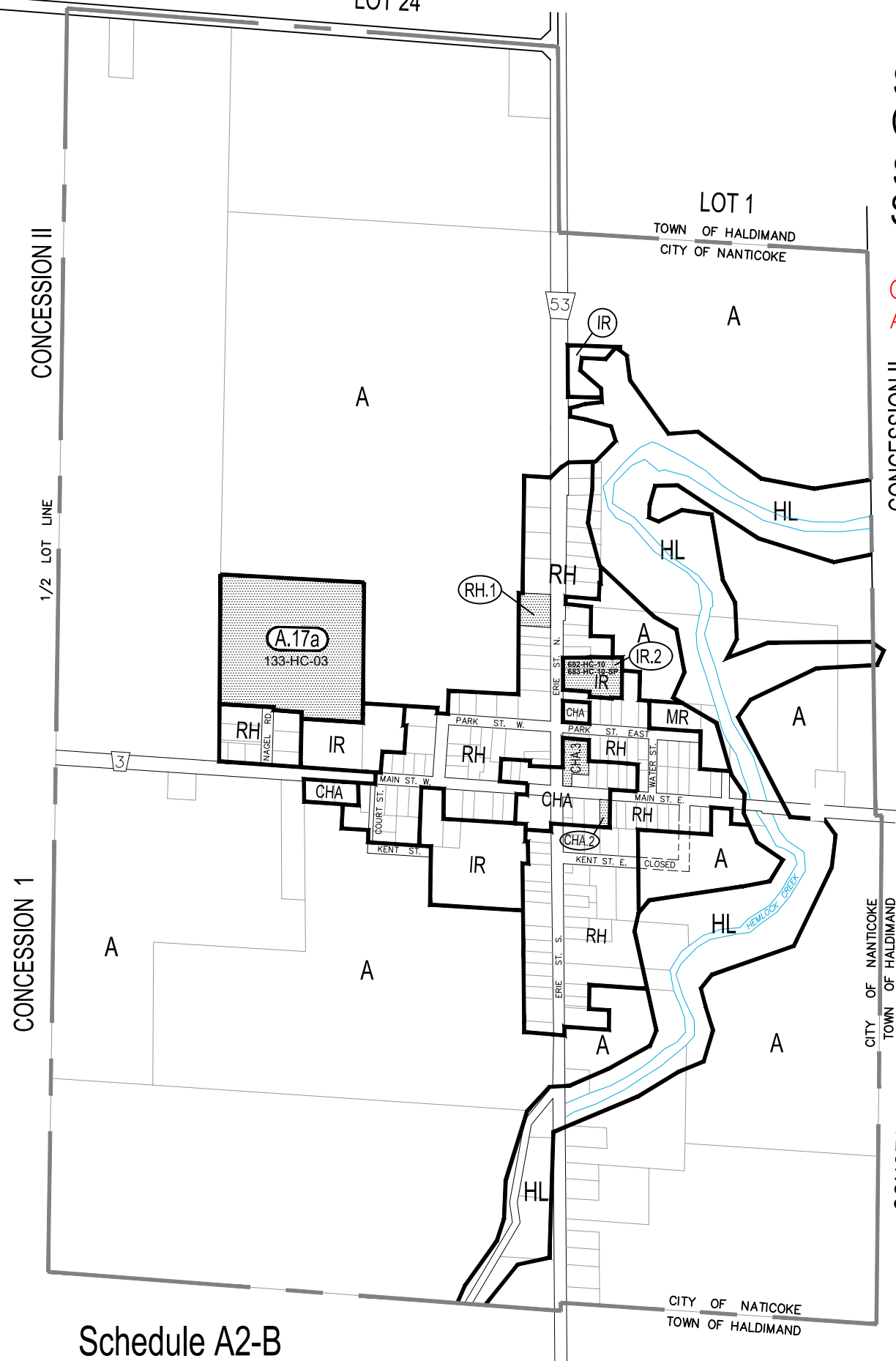

**Schedule A2-B  
Selkirk**

**NANTICOKE EAST**  
Schedule A2-A  
Cheapside  
Schedule A2-B  
Selkirk

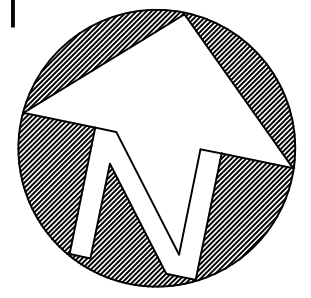

OFFICE CONSOLIDATION  
AUG 2018

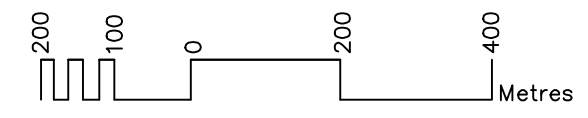

- Legend**
- SCHEDULE BOUNDARY
  - ZONE BOUNDARY
  - BOUNDARY OF LAND HAVING REFERENCE TO SPECIAL PROVISIONS OF THIS BY-LAW
  - BOUNDARY OF LAND HAVING REFERENCE TO SPECIAL PROVISIONS OF THIS BY-LAW
  - OFF STREET PARKING AREA (BY-LAW 632-HC-09)

\*NOTE: According to Section 1.4.8 of this By-law, all lands within R3, R4, R5, RM, CD, CN, CH, CHA, CR, CMT, MG, MH, MP, MR, MD, MX, IC, IN, IR, OS, OST, and HL zones are site plan control areas by By-law 749-HC/11

++NOTE: All Lands within the CH, CR, MH, MG and MR zones of Zoning By-Law NE 1-2000 are subject to By-Laws 1049-HC/18 & 1052-HC/18 which permits the use of a Scrap Material Collection Bin for a period of up to two (2) years expiring on Feb 12, 2020

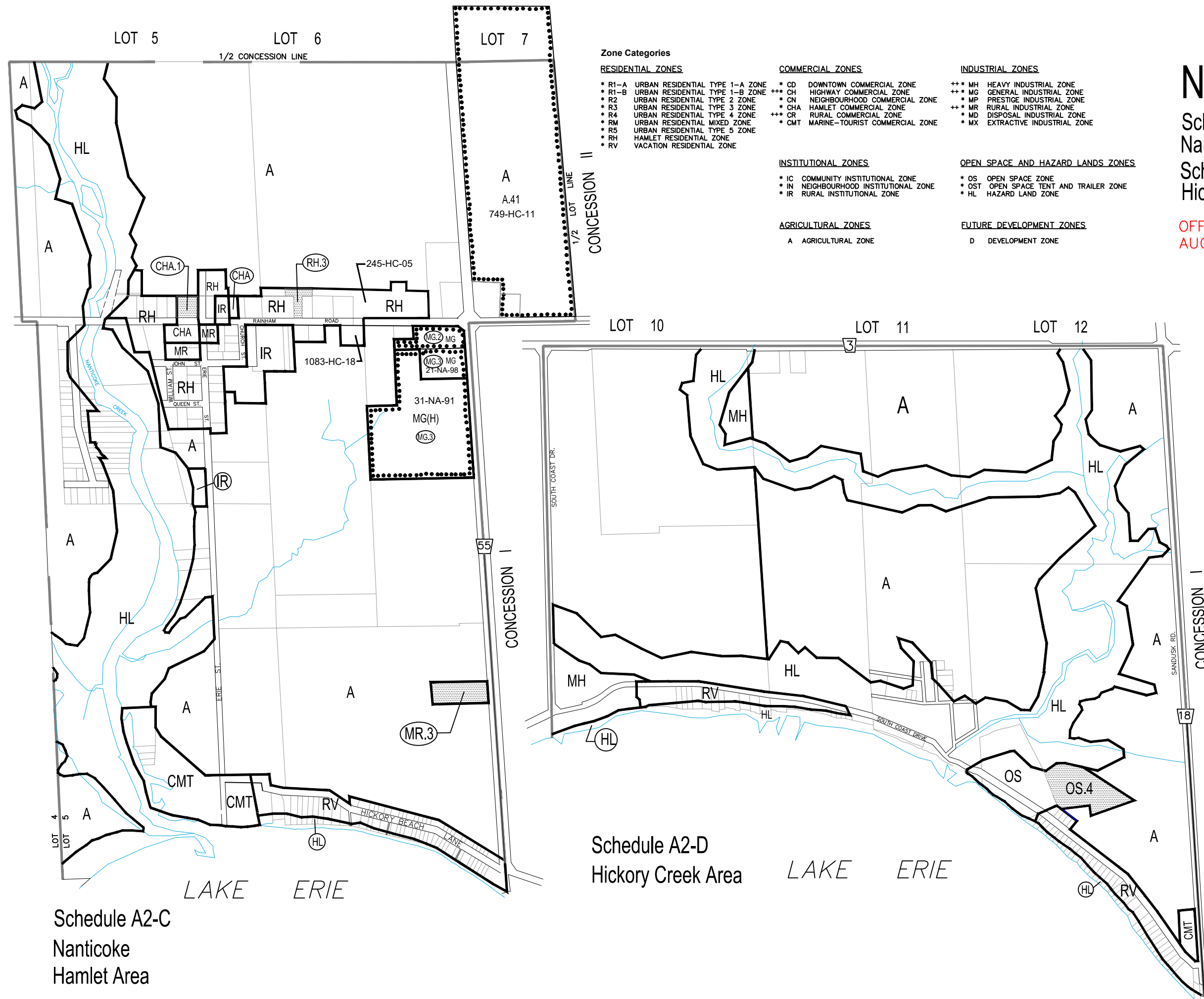

**Zone Categories**

<p><b>RESIDENTIAL ZONES</b></p> <ul style="list-style-type: none"> <li>* R1-A URBAN RESIDENTIAL TYPE 1-A ZONE</li> <li>* R1-B URBAN RESIDENTIAL TYPE 1-B ZONE</li> <li>* R2 URBAN RESIDENTIAL TYPE 2 ZONE</li> <li>* R3 URBAN RESIDENTIAL TYPE 3 ZONE</li> <li>* R4 URBAN RESIDENTIAL TYPE 4 ZONE</li> <li>* RM URBAN RESIDENTIAL MIXED ZONE</li> <li>* R5 URBAN RESIDENTIAL TYPE 5 ZONE</li> <li>* RH HAMLET RESIDENTIAL ZONE</li> <li>* RV VACATION RESIDENTIAL ZONE</li> </ul>	<p><b>COMMERCIAL ZONES</b></p> <ul style="list-style-type: none"> <li>* CD DOWNTOWN COMMERCIAL ZONE</li> <li>*** CH HIGHWAY COMMERCIAL ZONE</li> <li>* CN NEIGHBOURHOOD COMMERCIAL ZONE</li> <li>* CHA HAMLET COMMERCIAL ZONE</li> <li>*** CR RURAL COMMERCIAL ZONE</li> <li>* CMT MARINE-TOURIST COMMERCIAL ZONE</li> </ul>	<p><b>INDUSTRIAL ZONES</b></p> <ul style="list-style-type: none"> <li>*** MH HEAVY INDUSTRIAL ZONE</li> <li>*** MG GENERAL INDUSTRIAL ZONE</li> <li>* MP PRESTIGE INDUSTRIAL ZONE</li> <li>*** MR RURAL INDUSTRIAL ZONE</li> <li>* MD DISPOSAL INDUSTRIAL ZONE</li> <li>* MX EXTRACTIVE INDUSTRIAL ZONE</li> </ul>
<p><b>INSTITUTIONAL ZONES</b></p> <ul style="list-style-type: none"> <li>* IC COMMUNITY INSTITUTIONAL ZONE</li> <li>* IN NEIGHBOURHOOD INSTITUTIONAL ZONE</li> <li>* IR RURAL INSTITUTIONAL ZONE</li> </ul>	<p><b>OPEN SPACE AND HAZARD LANDS ZONES</b></p> <ul style="list-style-type: none"> <li>* OS OPEN SPACE ZONE</li> <li>* OST OPEN SPACE TENT AND TRAILER ZONE</li> <li>* HL HAZARD LAND ZONE</li> </ul>	<p><b>FUTURE DEVELOPMENT ZONES</b></p> <ul style="list-style-type: none"> <li>D DEVELOPMENT ZONE</li> </ul>
<p><b>AGRICULTURAL ZONES</b></p> <ul style="list-style-type: none"> <li>A AGRICULTURAL ZONE</li> </ul>		

# NANTICOKE EAST

Schedule A2-C  
Nanticoke Hamlet Area  
Schedule A2-D  
Hickory Creek Area

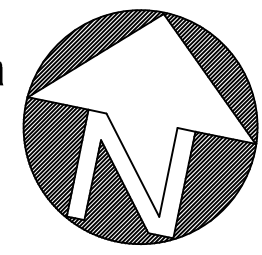

OFFICE CONSOLIDATION  
AUGUST 2018

**Legend**

- SCHEDULE BOUNDARY
- ZONE BOUNDARY
- BOUNDARY OF LAND HAVING REFERENCE TO SPECIAL PROVISIONS OF THIS BY-LAW
- BOUNDARY OF LAND HAVING REFERENCE TO SPECIAL PROVISIONS OF THIS BY-LAW
- OFF STREET PARKING AREA (BY-LAW 632-HC-09)

\*NOTE: According to Section 1.4.8 of this By-law, all lands within R3, R4, R5, RM, CD, CN, CH, CHA, CR, CMT, MG, MH, MP, MR, MD, MX, IC, IN, IR, OS, OST, and HL zones are site plan control areas by By-law 749-HC/11

\*\*\*NOTE: All Lands within the CH, CR, MH, MG and MR zones of Zoning By-Law NE 1-2000 are subject to By-Laws 1049-HC/18 & 1052-HC/18 which permits the use of a Scrap Material Collection Bin for a period of up to two (2) years expiring on Feb 12, 2020

Schedule A2-C  
Nanticoke  
Hamlet Area

Schedule A2-D  
Hickory Creek Area  
LAKE ERIE

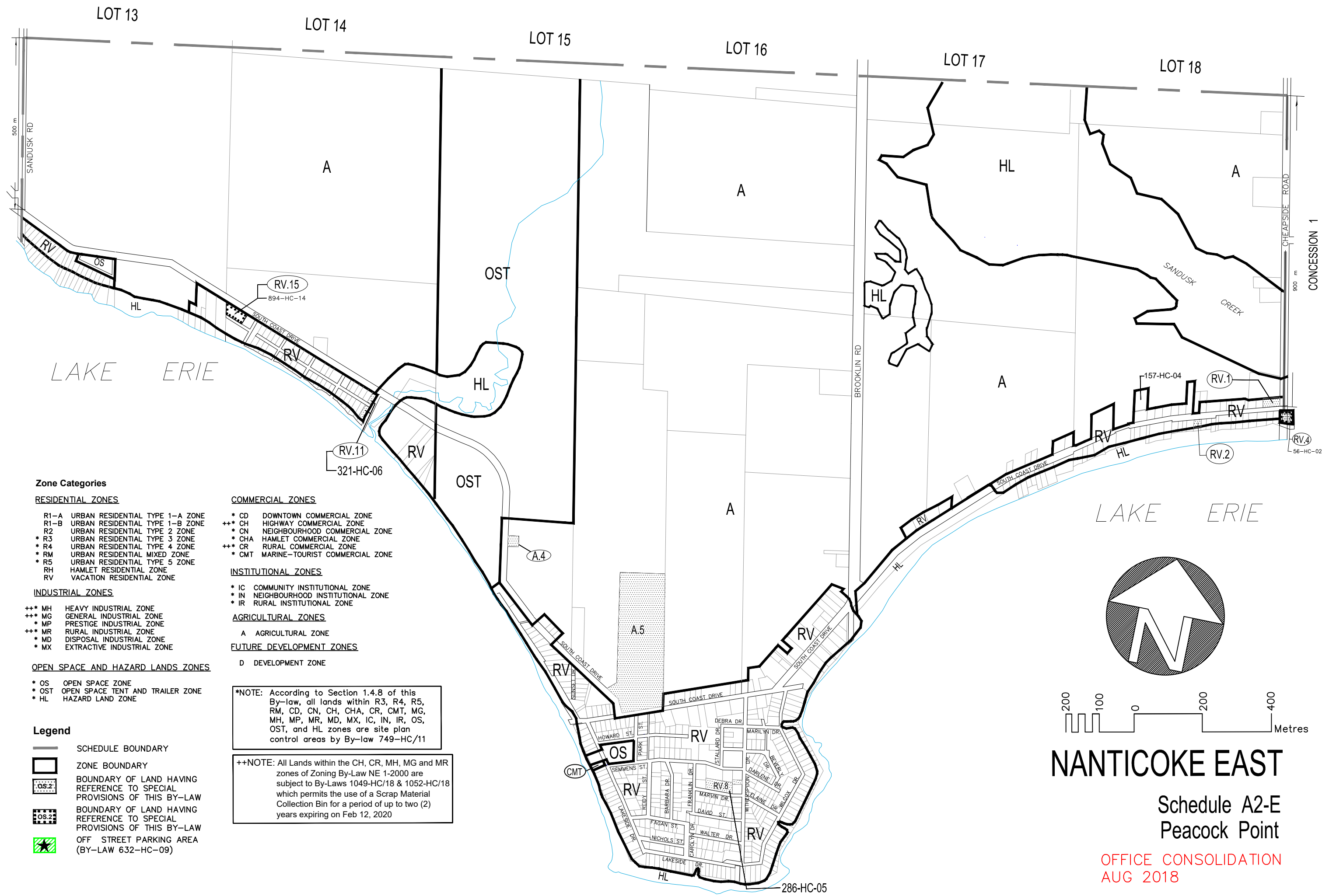

**Zone Categories**

**RESIDENTIAL ZONES**

- R1-A URBAN RESIDENTIAL TYPE 1-A ZONE
- R1-B URBAN RESIDENTIAL TYPE 1-B ZONE
- R2 URBAN RESIDENTIAL TYPE 2 ZONE
- \* R3 URBAN RESIDENTIAL TYPE 3 ZONE
- \* R4 URBAN RESIDENTIAL TYPE 4 ZONE
- \* RM URBAN RESIDENTIAL MIXED ZONE
- \* R5 URBAN RESIDENTIAL TYPE 5 ZONE
- RH HAMLET RESIDENTIAL ZONE
- RV VACATION RESIDENTIAL ZONE

**INDUSTRIAL ZONES**

- +++ MH HEAVY INDUSTRIAL ZONE
- +++ MG GENERAL INDUSTRIAL ZONE
- \* MP PRESTIGE INDUSTRIAL ZONE
- +++ MR RURAL INDUSTRIAL ZONE
- \* MD DISPOSAL INDUSTRIAL ZONE
- \* MX EXTRACTIVE INDUSTRIAL ZONE

**OPEN SPACE AND HAZARD LANDS ZONES**

- \* OS OPEN SPACE ZONE
- \* OST OPEN SPACE TENT AND TRAILER ZONE
- \* HL HAZARD LAND ZONE

**Legend**

- SCHEDULE BOUNDARY
- ZONE BOUNDARY
- OS.2 BOUNDARY OF LAND HAVING REFERENCE TO SPECIAL PROVISIONS OF THIS BY-LAW
- OS.2 BOUNDARY OF LAND HAVING REFERENCE TO SPECIAL PROVISIONS OF THIS BY-LAW
- OFF STREET PARKING AREA (BY-LAW 632-HC-09)

**COMMERCIAL ZONES**

- \* CD DOWNTOWN COMMERCIAL ZONE
- +++ CH HIGHWAY COMMERCIAL ZONE
- \* CN NEIGHBOURHOOD COMMERCIAL ZONE
- \* CHA HAMLET COMMERCIAL ZONE
- +++ CR RURAL COMMERCIAL ZONE
- \* CMT MARINE-TOURIST COMMERCIAL ZONE

**INSTITUTIONAL ZONES**

- \* IC COMMUNITY INSTITUTIONAL ZONE
- \* IN NEIGHBOURHOOD INSTITUTIONAL ZONE
- \* IR RURAL INSTITUTIONAL ZONE

**AGRICULTURAL ZONES**

- A AGRICULTURAL ZONE

**FUTURE DEVELOPMENT ZONES**

- D DEVELOPMENT ZONE

\*NOTE: According to Section 1.4.8 of this By-law, all lands within R3, R4, R5, RM, CD, CN, CH, CHA, CR, CMT, MG, MH, MP, MR, MD, MX, IC, IN, IR, OS, OST, and HL zones are site plan control areas by By-law 749-HC/11

++NOTE: All Lands within the CH, CR, MH, MG and MR zones of Zoning By-Law NE 1-2000 are subject to By-Laws 1049-HC/18 & 1052-HC/18 which permits the use of a Scrap Material Collection Bin for a period of up to two (2) years expiring on Feb 12, 2020

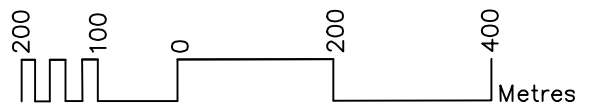
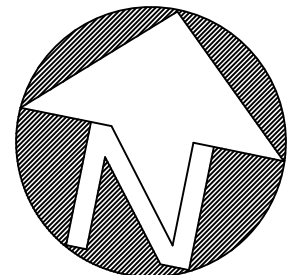

**NANTICOKE EAST**  
Schedule A2-E  
Peacock Point

OFFICE CONSOLIDATION  
AUG 2018

# SCHEDULE A2-F

OFFICE CONSOLIDATION  
AUGUST 2018

# NANTICOKE EAST WHEELER BEACH

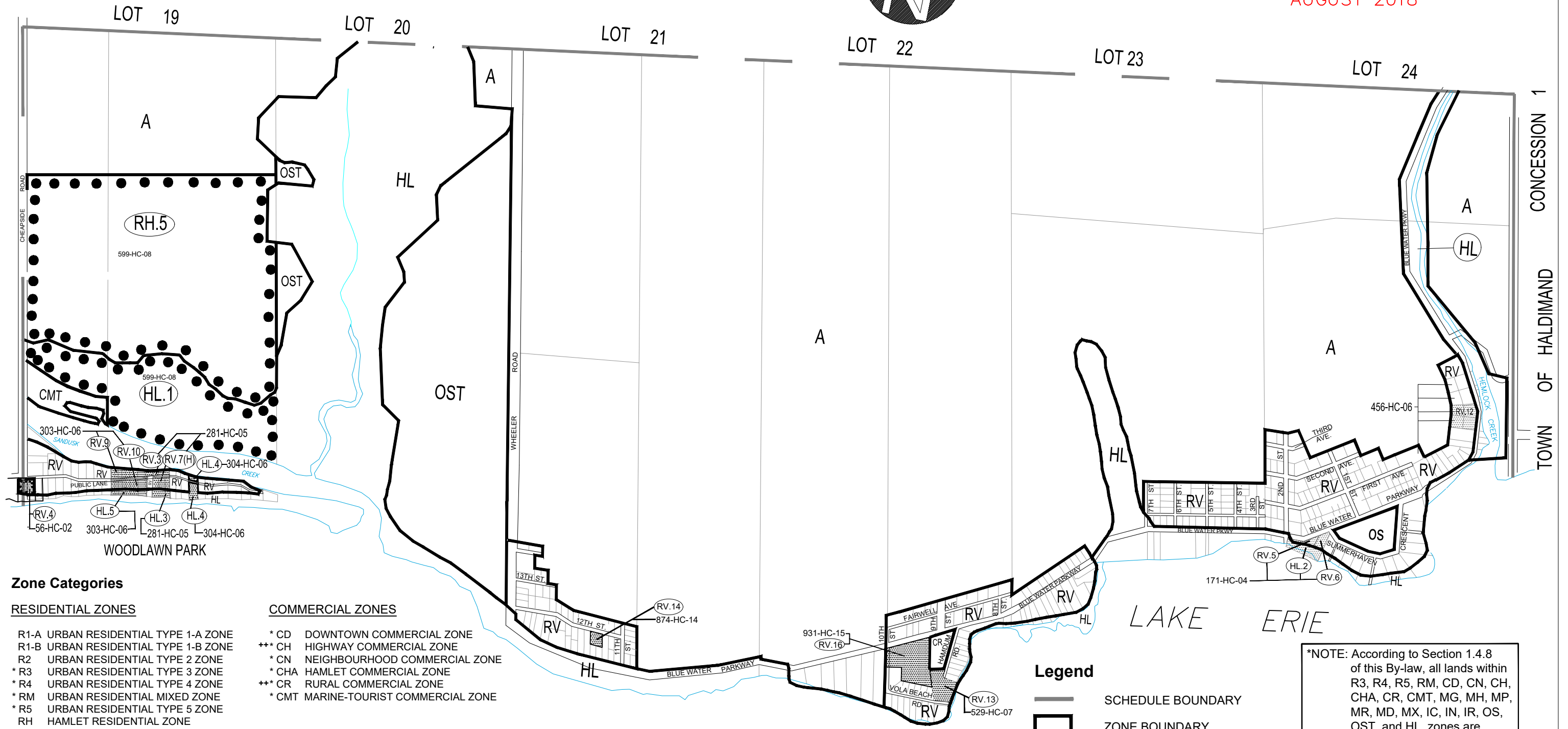
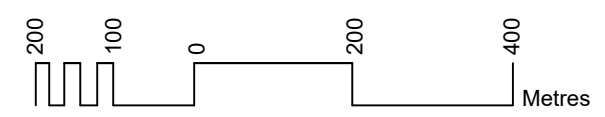
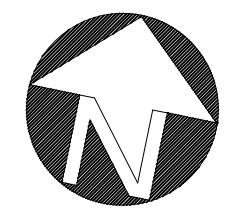

### Zone Categories

#### RESIDENTIAL ZONES

- R1-A URBAN RESIDENTIAL TYPE 1-A ZONE
- R1-B URBAN RESIDENTIAL TYPE 1-B ZONE
- R2 URBAN RESIDENTIAL TYPE 2 ZONE
- \* R3 URBAN RESIDENTIAL TYPE 3 ZONE
- \* R4 URBAN RESIDENTIAL TYPE 4 ZONE
- \* RM URBAN RESIDENTIAL MIXED ZONE
- \* R5 URBAN RESIDENTIAL TYPE 5 ZONE
- RH HAMLET RESIDENTIAL ZONE
- RV VACATION RESIDENTIAL ZONE

#### INDUSTRIAL ZONES

- +++ MH HEAVY INDUSTRIAL ZONE
- +++ MG GENERAL INDUSTRIAL ZONE
- \* MP PRESTIGE INDUSTRIAL ZONE
- +++ MR RURAL INDUSTRIAL ZONE
- \* MD DISPOSAL INDUSTRIAL ZONE
- \* MX EXTRACTIVE INDUSTRIAL ZONE

#### COMMERCIAL ZONES

- \* CD DOWNTOWN COMMERCIAL ZONE
- +++ CH HIGHWAY COMMERCIAL ZONE
- \* CN NEIGHBOURHOOD COMMERCIAL ZONE
- \* CHA HAMLET COMMERCIAL ZONE
- +++ CR RURAL COMMERCIAL ZONE
- \* CMT MARINE-TOURIST COMMERCIAL ZONE

#### INSTITUTIONAL ZONES

- \* IC COMMUNITY INSTITUTIONAL ZONE
- \* IN NEIGHBOURHOOD INSTITUTIONAL ZONE
- \* IR RURAL INSTITUTIONAL ZONE

#### AGRICULTURAL ZONES

- A AGRICULTURAL ZONE

#### OPEN SPACE AND HAZARD LANDS ZONES

- \* OS OPEN SPACE ZONE
- \* OST OPEN SPACE TENT AND TRAILER ZONE
- \* HL HAZARD LAND ZONE

#### FUTURE DEVELOPMENT ZONES

- D DEVELOPMENT ZONE

### Legend

- SCHEDULE BOUNDARY
- ZONE BOUNDARY
- BOUNDARY OF LAND HAVING REFERENCE TO SPECIAL PROVISIONS OF THIS BY-LAW
- BOUNDARY OF LAND HAVING REFERENCE TO SPECIAL PROVISIONS OF THIS BY-LAW
- OFF STREET PARKING AREA (BY-LAW 632-HC-09)

\*NOTE: According to Section 1.4.8 of this By-law, all lands within R3, R4, R5, RM, CD, CN, CH, CHA, CR, CMT, MG, MH, MP, MR, MD, MX, IC, IN, IR, OS, OST, and HL zones are site plan control areas by By-law 749-HC/11

+++NOTE: All Lands within the CH, CR, MH, MG and MR zones of Zoning By-Law NE 1-2000 are subject to By-Laws 1049-HC/18 & 1052-HC/18 which permits the use of a Scrap Material Collection Bin for a period of up to two (2) years expiring on Feb 12, 2020



# NANTICOKE EAST SCHEDULE A3 JARVIS

OFFICE CONSOLIDATION  
AUG 2020

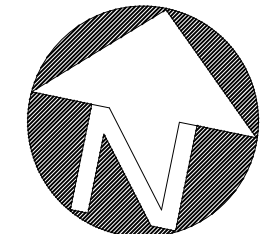
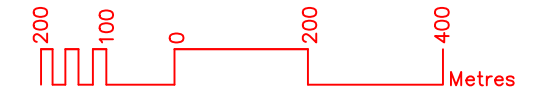

### Zone Categories

#### RESIDENTIAL ZONES

- R1-A URBAN RESIDENTIAL TYPE 1-A ZONE
- R1-B URBAN RESIDENTIAL TYPE 1-B ZONE
- R2 URBAN RESIDENTIAL TYPE 2 ZONE
- \* R3 URBAN RESIDENTIAL TYPE 3 ZONE
- \* R4 URBAN RESIDENTIAL TYPE 4 ZONE
- \* RM URBAN RESIDENTIAL MIXED ZONE
- \* R5 URBAN RESIDENTIAL TYPE 5 ZONE
- RH HAMLET RESIDENTIAL ZONE
- RV VACATION RESIDENTIAL ZONE

#### COMMERCIAL ZONES

- \* CD DOWNTOWN COMMERCIAL ZONE
- ++ CH HIGHWAY COMMERCIAL ZONE
- \* CN NEIGHBOURHOOD COMMERCIAL ZONE
- \* CHA HAMLET COMMERCIAL ZONE
- ++ CR RURAL COMMERCIAL ZONE
- \* CMT MARINE-TOURIST COMMERCIAL ZONE

#### INSTITUTIONAL ZONES

- \* IC COMMUNITY INSTITUTIONAL ZONE
- \* IN NEIGHBOURHOOD INSTITUTIONAL ZONE
- \* IR RURAL INSTITUTIONAL ZONE

#### INDUSTRIAL ZONES

- ++ MH HEAVY INDUSTRIAL ZONE
- ++ MG GENERAL INDUSTRIAL ZONE
- \* MP PRESTIGE INDUSTRIAL ZONE
- ++ MR RURAL INDUSTRIAL ZONE
- \* MD DISPOSAL INDUSTRIAL ZONE
- \* MX EXTRACTIVE INDUSTRIAL ZONE

#### OPEN SPACE AND HAZARD LANDS ZONES

- \* OS OPEN SPACE ZONE
- \* OST OPEN SPACE TENT AND TRAILER ZONE
- \* HL HAZARD LAND ZONE

#### FUTURE DEVELOPMENT ZONES

- D DEVELOPMENT ZONE

#### AGRICULTURAL ZONES

- A AGRICULTURAL ZONE

### Legend

- SCHEDULE BOUNDARY
- ZONE BOUNDARY
- BOUNDARY OF LAND HAVING REFERENCE TO SPECIAL PROVISIONS OF THIS BY-LAW
- BOUNDARY OF LAND HAVING REFERENCE TO SPECIAL PROVISIONS OF THIS BY-LAW
- OFF STREET PARKING AREA (BY-LAW 632-HC-09)

\*NOTE: According to Section 1.4.8 of this By-law, all lands within R3, R4, R5, RM, CD, CN, CH, CHA, CR, CMT, MG, MH, MP, MR, MD, MX, IC, IN, IR, OS, OST, and HL zones are site plan control areas by By-law 749-HC/11

++NOTE: All Lands within the CH, CR, MH, MG and MR zones of Zoning By-Law NE 1-2000 are subject to By-Laws 1049-HC/18 & 1052-HC/18 which permits the use of a Scrap Material Collection Bin for a period of up to two (2) years expiring on Feb 12, 2020

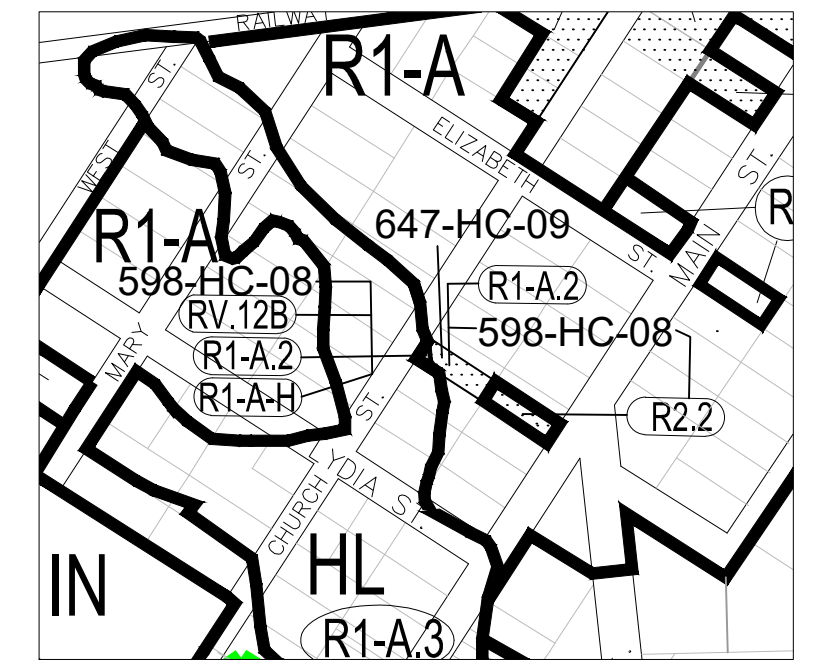
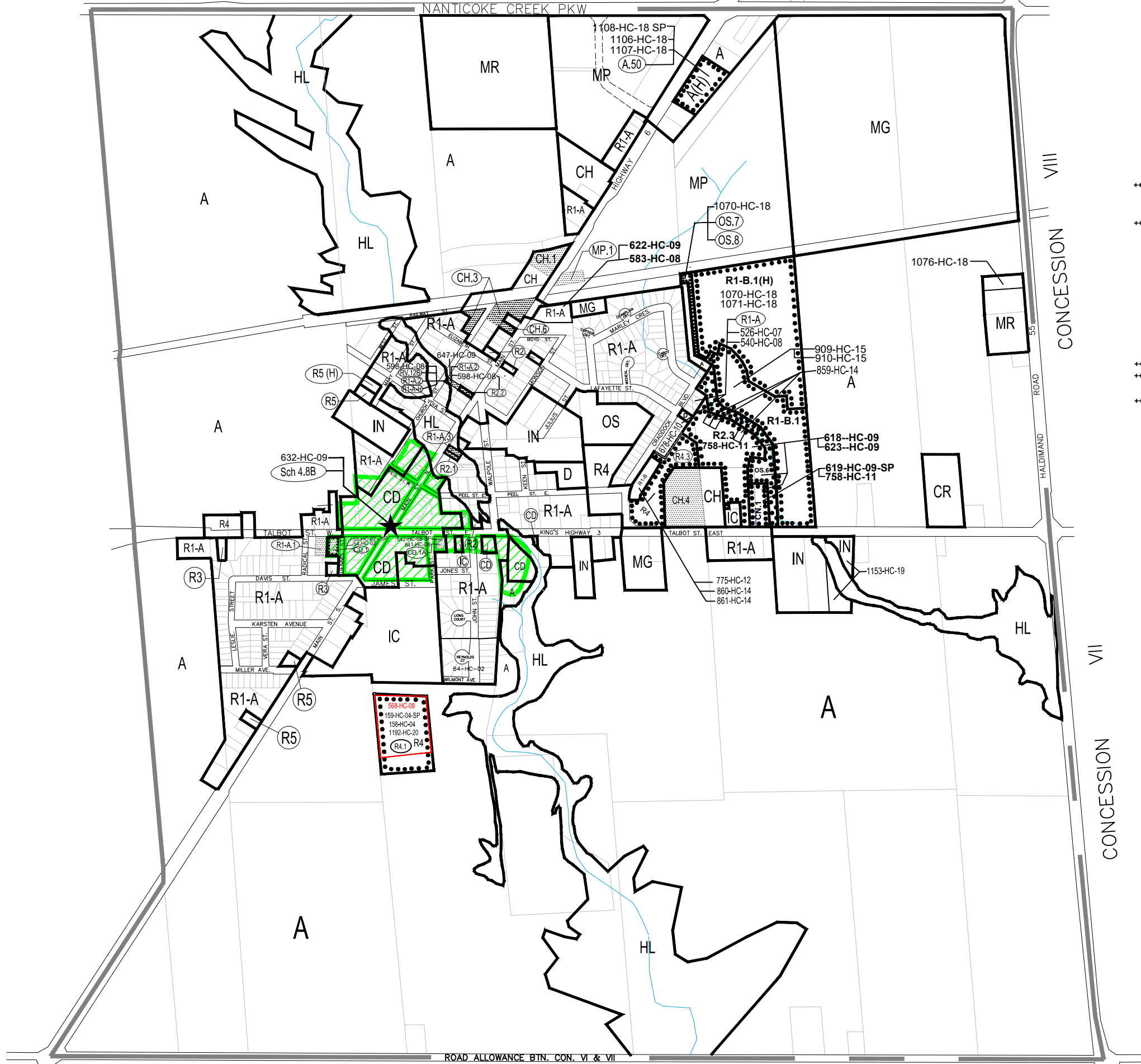

# NANTICOKE EAST SCHEDULE A4 TOWNSEND

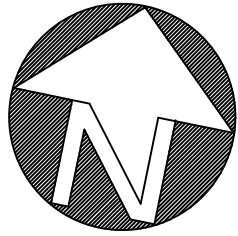

OFFICE CONSOLIDATION  
AUG 2018

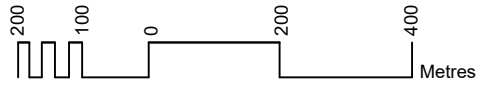

## Legend

- SCHEDULE BOUNDARY
- ZONE BOUNDARY
- BOUNDARY OF LAND HAVING REFERENCE TO SPECIAL PROVISIONS OF THIS BY-LAW
- BOUNDARY OF LAND HAVING REFERENCE TO SPECIAL PROVISIONS OF THIS BY-LAW
- OFF STREET PARKING AREA (BY-LAW 632-HC-09)

\*NOTE: According to Section 1.4.8 of this By-law, all lands within R3, R4, R5, RM, CD, CH, CN, CHA, CR, CMT, MG, MH, MP, MR, MD, MX, IC, IN, IR, OS, OST, and HL zones are site plan control areas by By-law 749-HC/11

+++NOTE: All Lands within the CH, CR, MH, MG and MR zones of Zoning By-Law NE 1-2000 are subject to By-Laws 1049-HC/18 & 1052-HC/18 which permits the use of a Scrap Material Collection Bin for a period of up to two (2) years expiring on Feb 12, 2020

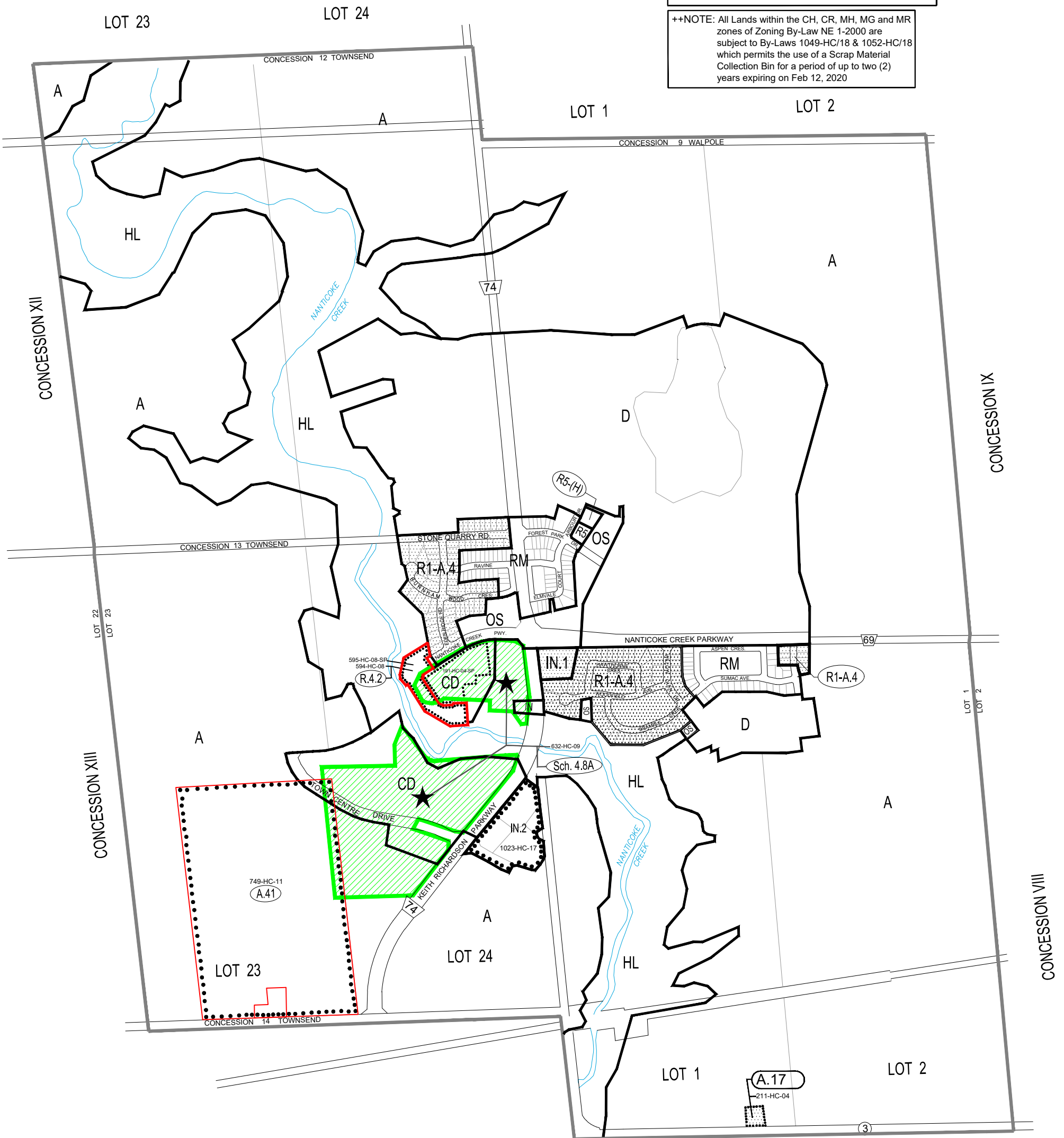

### Zone Categories

#### RESIDENTIAL ZONES

- R1-A URBAN RESIDENTIAL TYPE 1-A ZONE
- R1-B URBAN RESIDENTIAL TYPE 1-B ZONE
- R2 URBAN RESIDENTIAL TYPE 2 ZONE
- \* R3 URBAN RESIDENTIAL TYPE 3 ZONE
- \* R4 URBAN RESIDENTIAL TYPE 4 ZONE
- \* R5 URBAN RESIDENTIAL TYPE 5 ZONE
- \* RM URBAN RESIDENTIAL MIXED ZONE
- \* RH HAMLET RESIDENTIAL ZONE
- RV VACATION RESIDENTIAL ZONE

#### COMMERCIAL ZONES

- \* CD DOWNTOWN COMMERCIAL ZONE
- ++\* CH HIGHWAY COMMERCIAL ZONE
- \* CN NEIGHBOURHOOD COMMERCIAL ZONE
- \* CHA HAMLET COMMERCIAL ZONE
- ++\* CR RURAL COMMERCIAL ZONE
- \* CMT MARINE-TOURIST COMMERCIAL ZONE

#### INSTITUTIONAL ZONES

- \* IC COMMUNITY INSTITUTIONAL ZONE
- \* IN NEIGHBOURHOOD INSTITUTIONAL ZONE
- \* IR RURAL INSTITUTIONAL ZONE

#### INDUSTRIAL ZONES

- ++ MH HEAVY INDUSTRIAL ZONE
- ++ MG GENERAL INDUSTRIAL ZONE
- \* MP PRESTIGE INDUSTRIAL ZONE
- ++ MR RURAL INDUSTRIAL ZONE
- \* MD DISPOSAL INDUSTRIAL ZONE
- \* MX EXTRACTIVE INDUSTRIAL ZONE

#### OPEN SPACE AND HAZARD LANDS ZONES

- \* OS OPEN SPACE ZONE
- \* OST OPEN SPACE TENT AND TRAILER ZONE
- \* HL HAZARD LAND ZONE

#### AGRICULTURAL ZONES

- A AGRICULTURAL ZONE

#### FUTURE DEVELOPMENT ZONES

- D DEVELOPMENT ZONE

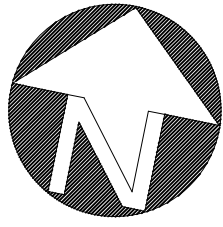

# NANTICOKE EAST

## SCHEDULE "C"

### Natural Features

OFFICE CONSOLIDATION  
FEBRUARY 2008

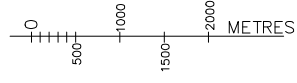

WETLANDS ARE SHOWN THUS -

OTHER NATURAL FEATURES ARE SHOWN THUS -

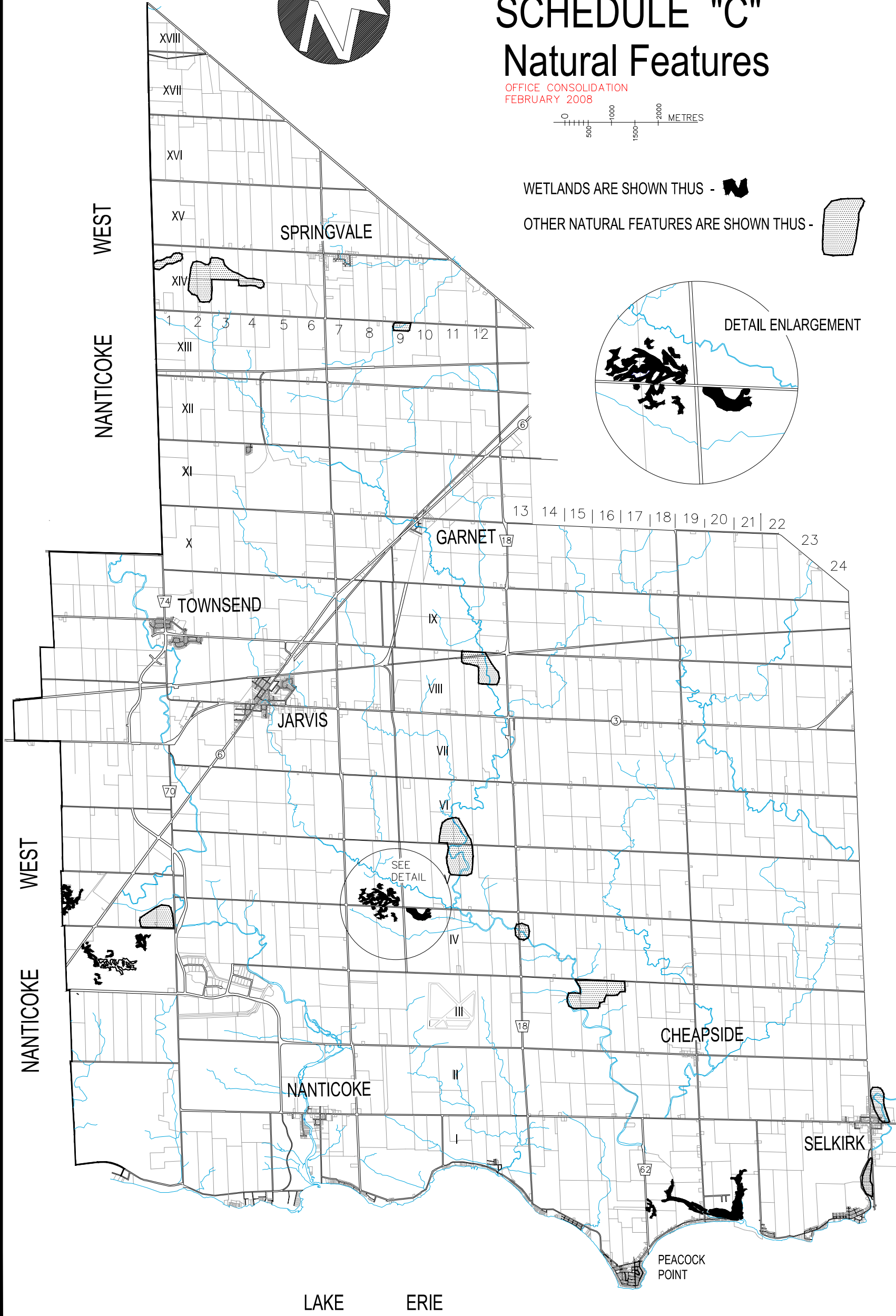
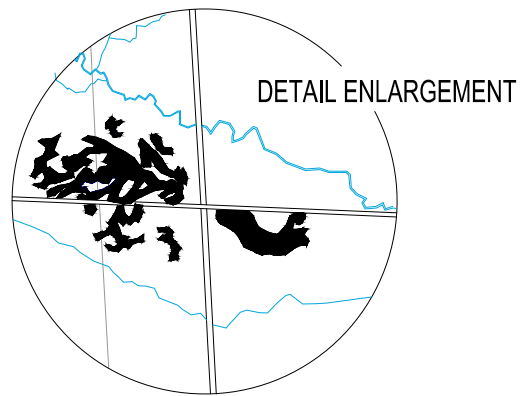

FORMER TOWNSHIP OF RAINHAM  
TOWN OF HALDIMAND

LAKE ERIE